

IRIN 109 CC

Ref. TINVPLASMA109/CC

| | |
|------------------------------|-------------------|
| Power supply | 3 x 400 Vac ± 15% |
| Frequency | 50/60 Hz |
| Input supply (60% - 100%) | 28 A - 19 A |
| Maximum input power | 19,5 KVA |
| No load voltage | 300 V |
| Cutting current 60% / 100% | 100 A / 70 A |
| Flow | 200 lpm |
| Pressure | 4,4 - 5,0 bar |
| Recommended cutting capacity | 25 mm |
| Maximum cutting capacity | 30 mm |
| Brute cutting capacity | 35 mm |
| Level protection | IP 23 S |
| Insulation class | H/F |
| Dimensions (mm.) | 195 x 570 x 360 |
| Weight | 21 Kg |



TORCH TM-100

Ref. PP09720CX/WLD

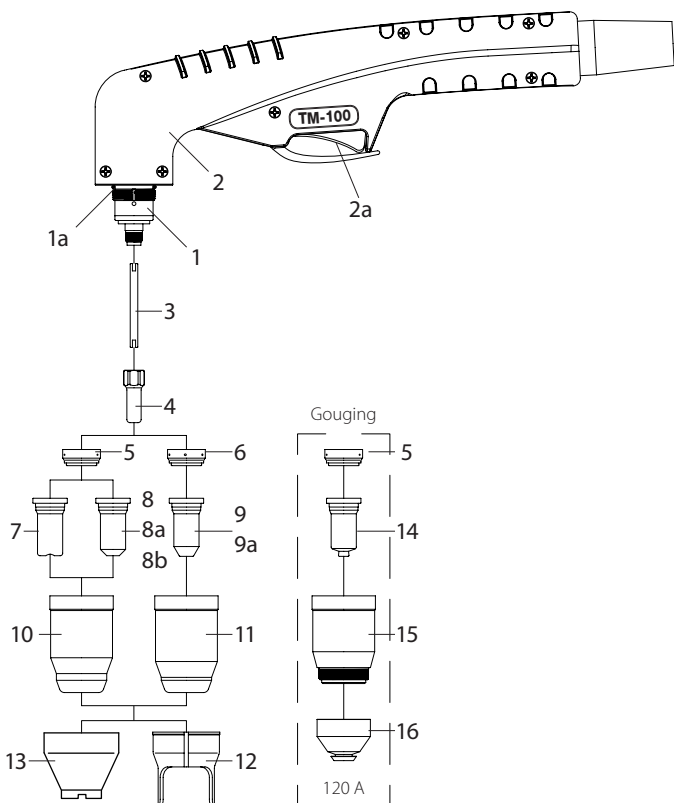

Pilot arc: Electrode against tip cutting
 Gas pressure: 70-80 psi (4,6-5,0 bar)
 Gas flow: 420 scfh (200 lpm)
 Duty cycle: 120 Amp 60%
 Ignition: Without HF
 Current: 30-120 Amp.
 Gas: Air/N2

| ITEM | CODE | DESCRIPTION |
|------|---------------|--|
| | PP09720CX/WLD | 70° Hand coaxial torch, 6 m (20 ft) length |
| | PP09780CX | Coaxial lead assembly, 6 m (20 ft) length |
| 1 | PP09700* | PT-100 70° torch head |
| 1a | PP51190.41* | O-ring |
| 2 | PP09705* | Handle with switch |
| 2a | PP07301.20* | Switch |
| 3 | PP09700.48* | Cooling tube |
| 4 | PP52556* | Electrode, back striking |
| 5 | PP60025 | Gas distributor (30-70 A) |
| 6 | PP60026* | Gas distributor (80-120 A) |
| 7 | PP51245.09 | Tip, contact cutting, Ø 0,90 (30-40 A) |
| 8 | PP51246.10 | Tip, cutting, Ø 1,00 (40-50 A) |
| 8a | PP51246.11 | Tip, cutting, Ø 1,10 (50-60 A) |
| 8b | PP51246.12 | Tip, cutting, Ø 1,20 (60-70 A) |
| 9 | PP51248.14 | Tip, cutting, Ø 1,40 (80-90 A) |
| 9a | PP51248.15* | Tip, cutting, Ø 1,50 (100-110 A) |
| 10 | PP60500 | Retaining cap (30-70 A) |
| 11 | PP60501* | Retaining cap (80-120 A) |
| 12 | PP60444* | Double pointed spacer |
| 13 | PP10002* | Shield cap hand TM-100 |
| 14 | PP51278G.22 | Tip, gouging, Ø 2,20 (120 A) |
| 15 | PP60502 | Retaining cup gouging |
| 16 | PP60508 | Shield cap gouging |

* Accessories included with the torch