

# IRIN 77 CC

Ref. TINVPLASMA77/CC

Power supply	3 x 400 Vac ± 15%
Frequency	50/60 Hz
Input supply (60% - 100%)	19 A - 15 A
Maximum input power	13,2 KVA
No load voltage	300 V
Cutting current 60% / 100%	70 A / 50 A
Flow	110 lpm
Pressure	4,4 - 5,0 bar
Recommended cutting capacity	15 mm
Maximum cutting capacity	18 mm
Brute cutting capacity	25 mm
Level protection	IP 23 S
Insulation class	H/F
Dimensions (mm.)	175 x 490 x 360
Weight	16 Kg



# TORCH TM-80

Ref. PP09821CX/WLD

Pilot arc: Electrode against tip cutting  
 Gas pressure: 65-75 psi (4,4-5,0 bar)  
 Gas flow: 230 scfh (110 lpm)  
 Duty cycle: 80 Amp 60%  
 Ignition: Without HF  
 Current: 30-80 Amp.  
 Gas: Air/N2

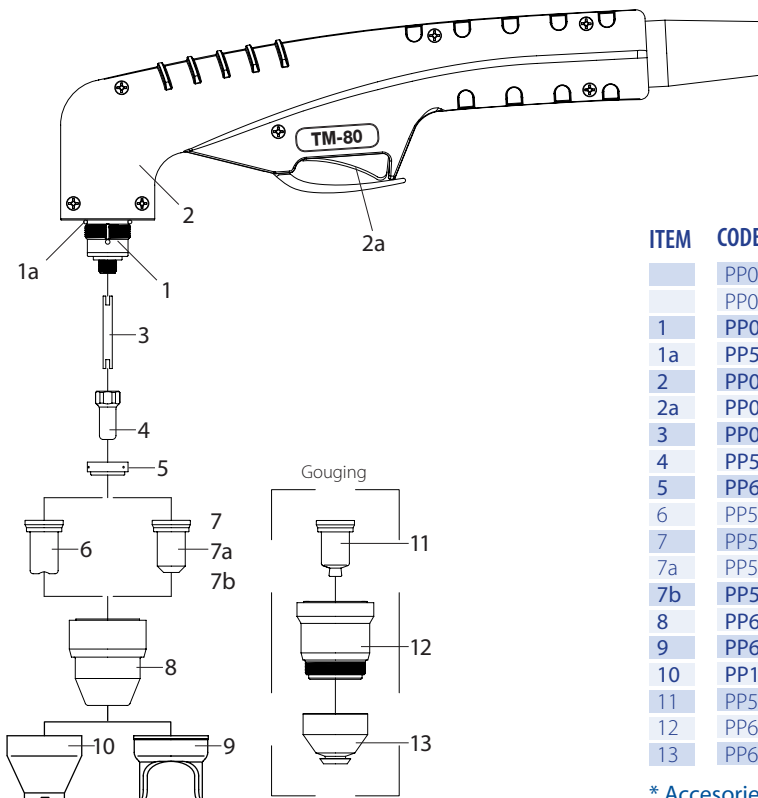

ITEM	CODE	DESCRIPTION
	PP09821CX/WLD	70° Hand coaxial torch, 6 m (20 ft) length
	PP09780CX	Coaxial lead assembly, 6 m (20 ft) length
1	PP09800*	PT-80 70° torch head
1a	PP51620.60*	O-ring
2	PP09705*	Handle with switch
2a	PP07301.20*	Switch
3	PP09800.42*	Cooling tube
4	PP52558*	Electrode, back striking
5	PP60027*	Gas distributor
6	PP51310.09	Tip, contact cutting, Ø 0,90 (30-40 A)
7	PP51311.10	Tip, contact cutting, Ø 1,00 (40-50 A)
7a	PP51311.11	Tip, contact cutting, Ø 1,10 (50-60 A)
7b	PP51311.12*	Tip, contact cutting, Ø 1,20 (60-70 A)
8	PP60510*	Retaining cap
9	PP60434*	Double pointed spacer
10	PP10001*	Shield cap hand TM-80
11	PP51311G.16	Tip, gouging, Ø 1,60 (80 A)
12	PP60511	Retaining cup gouging
13	PP60508	Shield cap gouging

\* Accessories included with the torch