

IRIN 46 CC/CI

Ref. TINVPLASMA46/CC Ref. TINVPLASMA46/CI

Power supply	230Vac ± 15%
Frequency	50/60 Hz
Input supply (100%)	29 A
Maximum input power	6,6 KVA
No load voltage	300 V
Cutting current 100%	40 A
Flow	100 lpm
Pressure	4,4 - 5,0 bar
Recommended cutting capacity	10 mm
Maximum cutting capacity	12 mm
Brute cutting capacity	15 mm
Level protection	IP 23 S
Insulation class	H/F
Dimensions (mm.)	175 x 490 x 360
Weight	14,5 Kg



TORCH TM-40

Ref. PP09636/TM CI Ref. PP09637/TM CC

Pilot arc: Electrode against tip cutting
 Gas pressure: 65-75 psi (4,4-5,0 bar)
 Gas flow: 230 scfh (110 lpm)
 Duty cycle: 40 Amp 100%
 Ignition: Without HF
 Current: 10-60 Amp.
 Gas: Air/N2

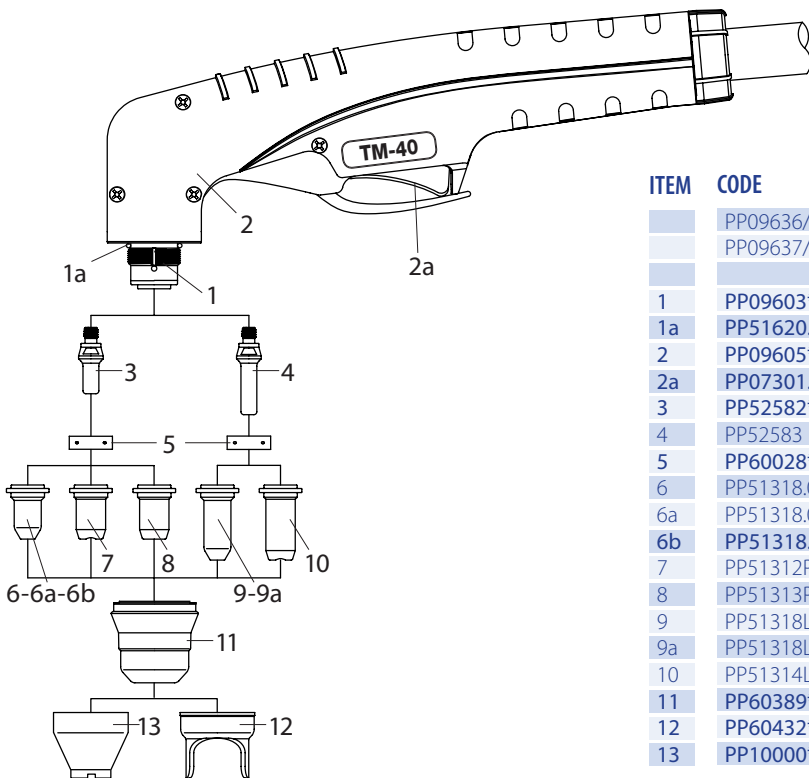

ITEM	CODE	DESCRIPTION
	PP09636/TM	70° Hand torch, 6 m (20 ft) length CI
	PP09637/TM	70° Hand coaxial torch, 6 m (20 ft) length CC
		Coaxial lead assembly, 6 m (20 ft) length
1	PP09603*	PT-60 70° torch head
1a	PP51620.60*	O-ring
2	PP09605*	Handle with switch
2a	PP07301.20*	Switch
3	PP52582*	Electrode, back striking
4	PP52583	Extended electrode, back striking
5	PP60028*	Gas distributor
6	PP51318.06	Tip, contact cutting, Ø 0,65 (10-20 A)
6a	PP51318.08	Tip, contact cutting, Ø 0,80 (20-30 A)
6b	PP51318.10*	Tip, contact cutting, Ø 1,00 (40-50 A)
7	PP51312P.09	Tip, contact cutting, Ø 0,90 (30-40 A)
8	PP51313P.10	Flat tip, contact cutting, Ø 1,00 (40-50 A)
9	PP51318L.06	Extended tip, contact cutting, Ø 0,65 (10-20 A)
9a	PP51318L.08	Extended tip, contact cutting, Ø 0,80 (20-30 A)
10	PP51314L.09	Extended tip, contact cutting, Ø 0,90 (30-40 A)
11	PP60389*	Retaining cap, 6 holes
12	PP60432*	Double pointed spacer
13	PP10000*	Shield cap hand TM-40

* Accessories included with the torch